

Power generation capacity	80W
Battery capacity	256Wh
LED lighting power consumption	4W
Surface treatment	Hot-dip galvanized
Weight	approx. 75kg

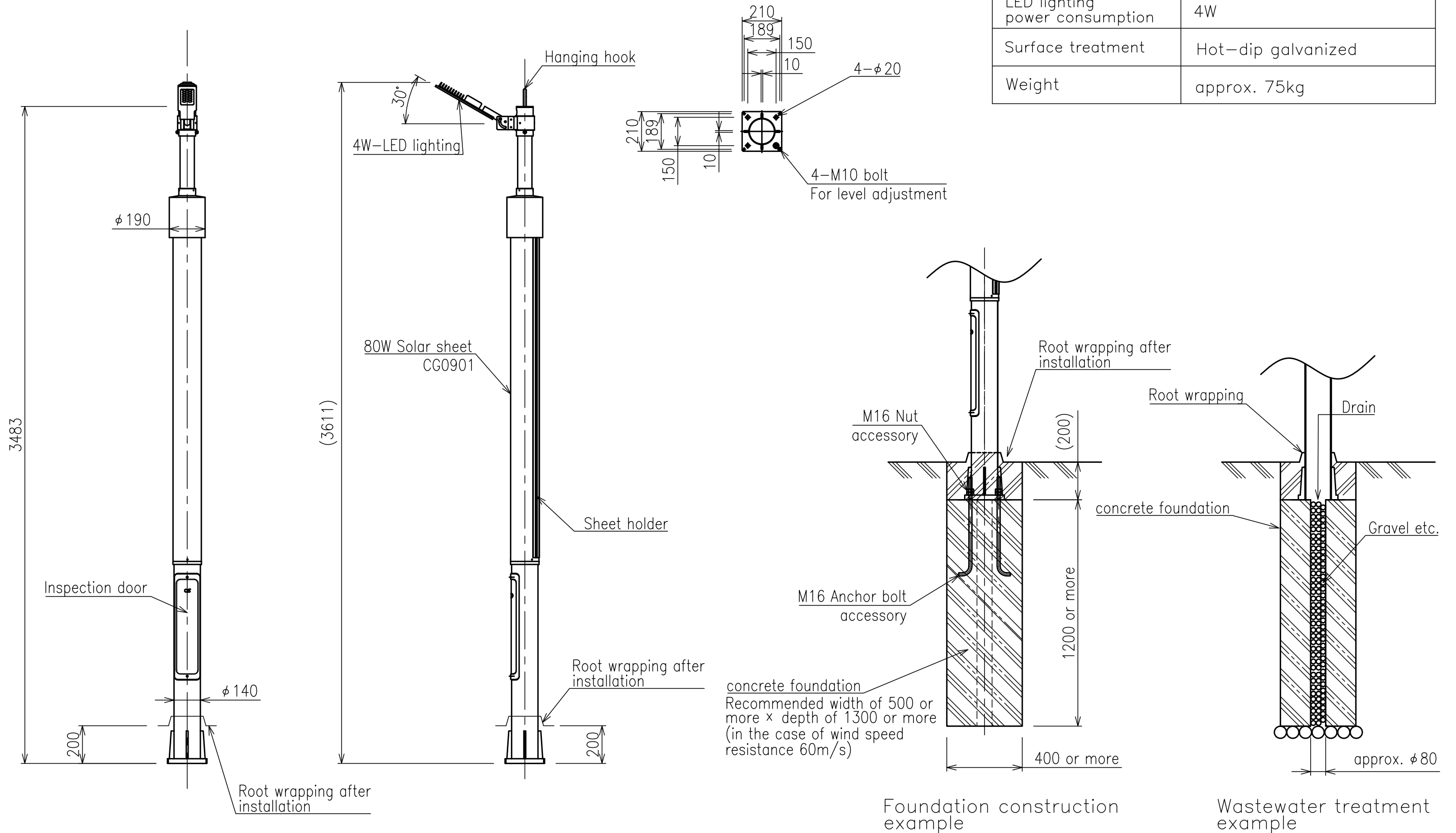

concrete foundation
Recommended width of 500 or more \times depth of 1300 or more
(in the case of wind speed resistance 60m/s)

Foundation construction example

Wastewater treatment example

The foundation construction example and wastewater treatment example is based for the Japanese popular standard of construction work.